

Explosion Proof High Bay LED Luminaires

Date:..... Location:

Product:..... Project:.....

Quantity:..... Catalog#



FEATURES

- High bay design, Class 1 Division 2, Group A B C D, Class 2, Division 2, group F and G, class 3, hazardous environment.
- LED: LM80 certified, high efficacy, low decay, long lifespan.130 lm /W ±5, up to 10400lm.
- Lens -tempered glass shock & vibration resistant, Super clear,>90% light transmit.
- IP66 RATED. Housing - Aluminum alloy.
- Meanwell LED Driver,>90% driver efficacy
- 6KV Surge Protection

SUITABLE APPLICATIONS

Applicate in Class I, Division 2, Groups A, B, C and D;
Class II, Division 2, Groups F and G;
Class III hazardous environment, Certificate No: E475887-UL-CUL

- Waste water treatment, oil and gas refineries, drilling rigs, offshore platforms, petrochemical facilities, chemical plants, coal mines, aviation bases, food plant, Pharmaceutical plant, beverage facilities, and where flammable vapors, gases, ignitable dusts, fibers or flyings are present.

CONSTRUCTION:

Heavy die-cast aluminum alloy housing with black powder-coated finish. Tempered Glass lens,4J impact resistance.

ELECTRICAL:

Available as 120-277V input. -40°C to 60°C.

OPTICAL SYSTEM:

Lumileds LED chips. High quality tempered glass optics.180° beam angle.

INSTALLATION&MOUNTING:

Ceiling mount /Drop mount/ U bracket mount

WARRANTY:

5-year limited warranty. Actual performance may differ as a result of end-user environment and application.

PERFORMANCE

Model NO	Power Factor	Wattage	Voltage/Current Input		Light Efficiency	Kelvin Options
			120V	277V		
CES-EX-D-GBX-300-50	0.9	300W	2.5A	1.08 A	>130LM	5000K

Explosion Proof High Bay LED Luminaires

Electric Characteristic

Specification/Model	CES-EX-D-GBX-300-50
LED DRIVER	UL Driver
Input power	300W
Lumens output	>39000LM
Efficiency	>130LM/W
CRI	>72
Color Temperature	5000K
Input voltage	120-277V/AC
Light distribution type	105D
Working temperature	-40 -+60°C
Anticorrosion grade	WF1/WF2(Custom)
Explosion-proof mark	Ex db IIC T6 Gb; Ex tb IIIC T80°C Db
Certificate	UL CUL DLC
Equivalent	600-1000W MH/HPS

PRODUCT ORDERING GUIDE

CES-EX-D-GBX-300-50
1 2 3 4

CES - EX-D-GBX - 300 - 50

- CES
- EX-D-GBX Explosion Proof Low bay LED
- 300 Power 300W
- 50 CCT:5000K

DIMENSION

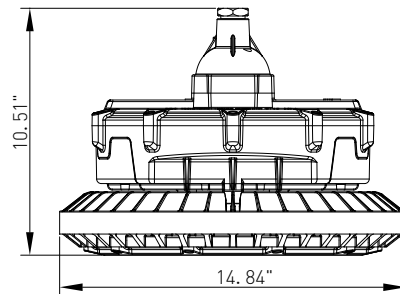

DISTRIBUTION DIAGRAM

CES-EX-D-GBX-300-50

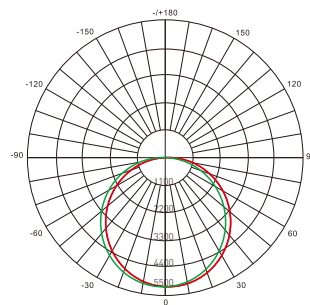

AVERAGE BEAM ANGLE(50%): 108°

- UNIT: CD
- C0/180, 119.9
 - C30/210, 109.9
 - C60/240, 101.7
 - C90/270, 110.1
- Lumens: 42000 LM
 Test Number: 300W
 Test Number: 5000K

Installation

(Take ceiling type for example)

1. The installation of explosion-proof lights must be installed by professionals;
2. Operation process:
 - (a) Remove the cable sleeve, take out the sealing assembly, and select the cable that meets the requirements;
 - (b) Connect the cable to the terminal reliably, and connect the internal ground wire;
 - (c) Press the sealing ring to make the cable reliably clamped and sealed;
 - (d) Screw the lamp in place and lock the screw.

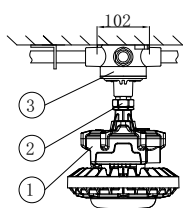

Ceiling type(x)

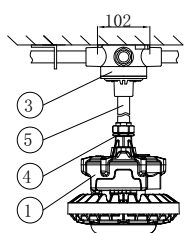

Derrick type(g)

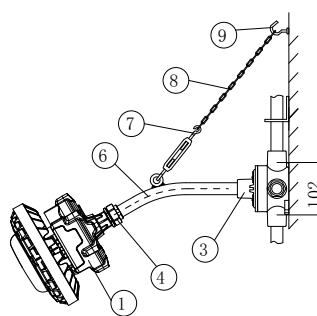

Wall type 30°(b1)

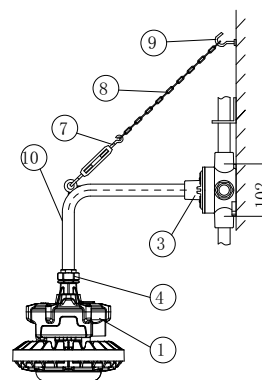

Wall type 90°(b2)

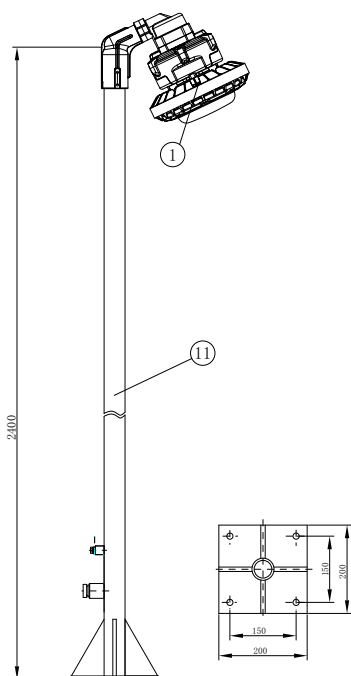

Flange type(f)

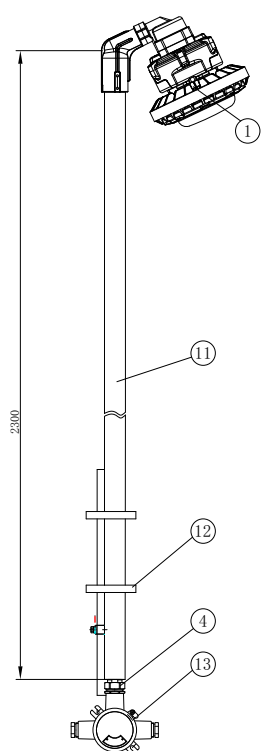

Guardrail type(h)