

5CCT LED Disk Light



Date: Location:

Product: Project:

Quantity: Catalog#

FEATURES

- 4" 6" 5CCT disk lights, Low profile, 90CRI.
- Smooth dimming from 100% to 5% with many Triac Dimmers
- Wet location rated. ETL ENERGY STAR LISTED.

SUITABLE APPLICATIONS

- Office Lighting
- Meeting room lighting
- Store lighting
- Restaurant lighting



CONSTRUCTION:

A flexible downlight solution supports surface mounting and retrofit installation. High quality Iron shell with frosted PC diffuser. Features color tunable technology lets the user choose between 2700K, 3000K, 3500K, 4000K, or 5000K. Wet-location rated, ideal for bathrooms, laundry, porches and garage work rooms.

OPTICAL SYSTEM:

Super Bright 2835 LEDs. High Transmission PC cover. 120° beam angle.

WARRANTY:

5-year limited warranty. Actual performance may differ as a result of end-user environment and application.

ELECTRICAL:

This fixture is built with the highest quality 120V drivers, ensuring energy efficiency. Compatible with most triac dimmers to give user a smooth 100%-5% dimming to choose the desired brightness. Please check the recommended dimmers list in next page.

INSTALLATION & MOUNTING:

With multiple apertures, can be installed into any 5 or 6 inch Recessed Can, or 2.75/3.5 inch and 4 inch Junction Box, ideal for under soffit and shower installations.

PERFORMANCE

Model NO	PFC	Wattage	Size	Voltage/Current Input	Light Efficiency	Tunable CCT
				120V		
4HVCT10DK5WH	>0.9	10W	4inch	0.083A	80LM/W	27K/30K/35K/40K/50K
6HVCT15DK5WH	>0.9	15W	6inch	0.125A	80LM/W	27K/30K/35K/40K/50K

5CCT LED Disk Light

Electric Characteristic

Specification/Model	4HVCT10DK5WH	6HVCT15DK5WH
LED Driver	DOB Driver	
Input power	10W	15W
Lumens output	800LM	1200LM
Efficiency	80LM/W	80LM/W
CRI	>90	>90
Color Temperature	27K/30K/35K/40K/50K	27K/30K/35K/40K/50K
Input voltage	120AC	120AC
Light distribution type	120D	120D
Working temperature	-20+45°C	-20+45°C
Junction temperature	<75°C	<75°C
lamps efficiency	≥90%	≥90%
Certificate	ENERGY STAR ETL cETL	
Equivalent	18-27W MH/HPS	27-36W MH/HPS

OPTIONAL ACCESSORIES

2700K 3000K 3500K 4000K 5000K

CCT

CCT tunable Function

Catalog Numb Project Name : Note Date Type:

Anticlockwise to open the outside lens

Flip the switch to choose desired CCT

PRODUCT VIEW

4"

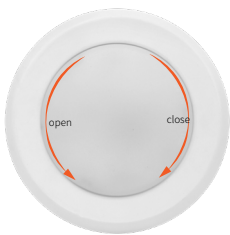

6"

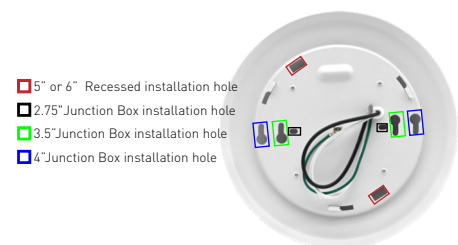
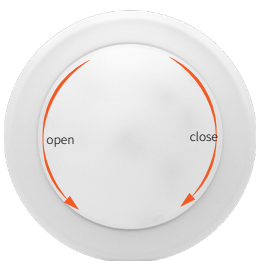

5CCT LED Disk Light

DIMENSION

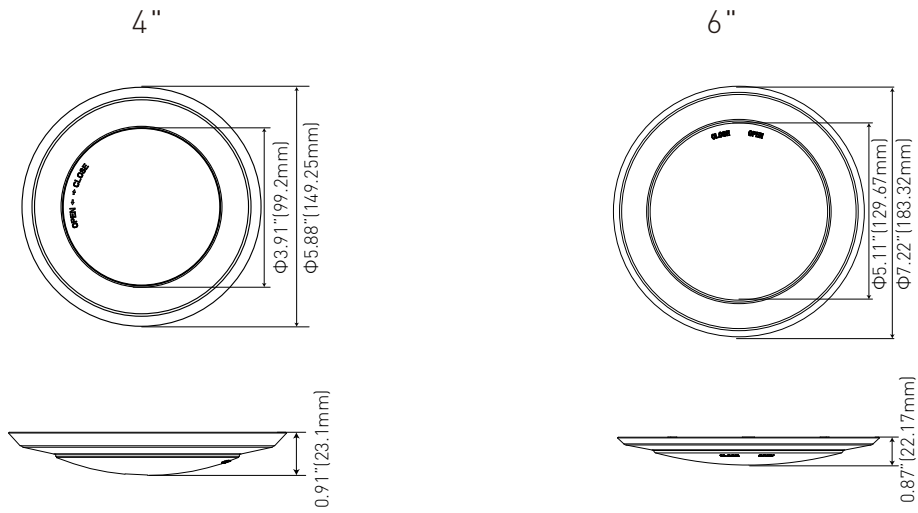

INSTALLATION ACCESSORIES

4"



Wire Nuts



Screws

6"



a Wire Nuts



b Screws



c E26 Adapter



d Mounting Springs

SURFACE MOUNT ACCESSORIES

PART	DESCRIPTION	PART
a	Wire Nuts	3
b	Screws	2

RETROFIT ACCESSORIES

QUANTITY	DESCRIPTION	QUANTITY
a	Wire Nuts	3
c	E26 Adapter	1
d	Mounting Springs	2

RECOMMENDED DIMMERS

LUTRON				LEVITON	
TG-600PR-WH	TGCL-153PH-LA	SCL-153PH-WH	PD-6WCL	6672	
S-600PR-WH	SLV-600P-AL	GT-600P	MSCL-OP153M	6674	PL06
CTCL-153PDH-WH	DV-600PR-WH	DVCL-153P	MACL-153M//MA-R	DSL06	RNL06

5CCT LED Disk Light

DISTRIBUTION DIAGRAM

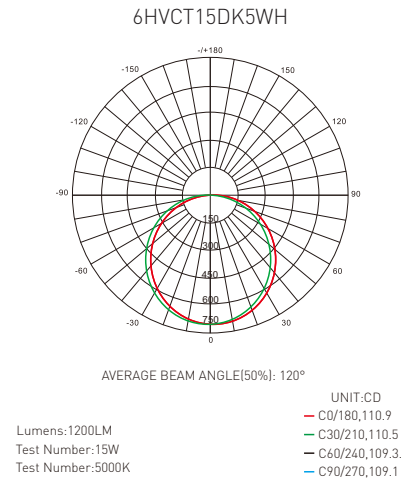
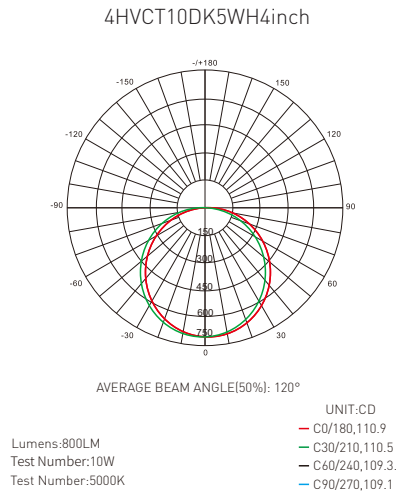

INSTALLATION STEPS

2. Make sure power off and the Junction Box is securely mounted before installation. (4" disk light is compatible with 4" Junction Box (hole spacing 3.5"), 6" disk light is compatible with 3" Junction Box (hole spacing 2.75") or 4" Junction Box (hole spacing 3.5")), see Fig 1.

2. Remove lens by twisting counterclockwise, see Fig 2

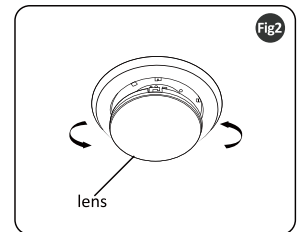
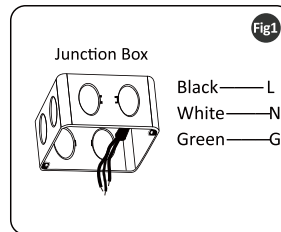

3. Select lamp color desired with the CCT switch at the front of the disk light, see Fig 3.

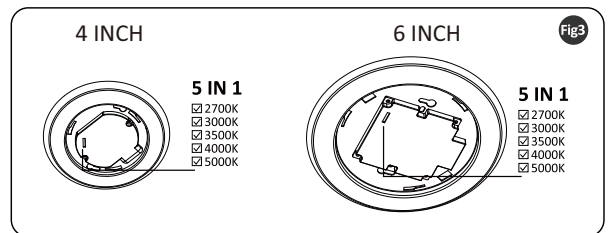

4. Connect the supply wires to the wires of disk light by using 3 wire nuts. Attach white to white, black to black, green to the ground wire, see Fig 4.

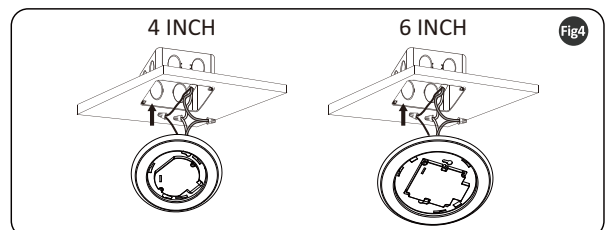

5CCT LED Disk Light

5. Arrange the wires into the Junction Box. Align appropriate slots in the disk light with the holes in the Junction Box. Use 2 screws to attach the disk light, flush with the ceiling, see Fig5.

6. Placing the lens back into it's original position by twisting it in clockwise direction, see Fig6.

7. Seal the edge of the fixture and the lens by using the waterproof sealant, see Fig7.

